

KEY	QTY	BOTANICAL/ COMMON NAME	SIZE	REMARK
AS	11	<i>Acer saccharum</i> SUGAR MAPLE	60mm Cal. WB.	--
AL	9	<i>Amelanchier leavis</i> ALICEHENY SERVICEBERRY	200cm ht. 10 gal. pot.	MULTISTEM
BA	5	<i>Betula alleghaniensis</i> YELLOW BIRCH	45mm Cal. WB.	MULTISTEM
CM	9	<i>Crataegus mollis</i> RED HAWTHORN	50mm Cal. WB.	--
TA	8	<i>Tilia americana</i> BASSWOOD	60mm Cal. WB.	--
JV	7	<i>Juniperus virginiana</i> EASTERN RED CEDAR	200cm ht. WB.	--
PG	6	<i>Picea glauca</i> WHITE SPRUCE	250cm ht. WB.	--
PS	4	<i>Pinus strobus</i> EASTERN WHITE PINE	250cm ht. WB.	--
TC	6	<i>Tsuga canadensis</i> EASTERN HEMLOCK	200cm ht. WB.	--
TO	32	<i>Thuja occidentalis</i> EASTERN WHITE CEDAR	200cm ht. WB.	--

KEY	QTY	BOTANICAL/COMMON NAME	SIZE	REMARK
ro	12	<i>Rubus odoratus</i> PURPLE-FLOWERING RASPBERRY	50cm ht. 3.0 gal. pot.	PLANT AT 2.0m O.C.
IT	8	<i>Rhus typhina</i> STAGHORN SUMAC	80cm ht. 3.0 gal. pot.	PLANT AT 1.0m O.C.
sc	4	<i>Sambucus canadensis</i> AMERICAN ELDER	50cm ht. 3.0 gal. pot.	PLANT AT 2.0m O.C.
sa	20	<i>Symphoricarpos albus</i> WHITE SNOWBERRY	50cm ht. 3.0 gal. pot.	PLANT AT 1.0m O.C.
tc	34	<i>Taxus canadensis</i> CANADA YEW	50cm ht. 3.0 gal. pot.	PLANT AT 1.0m O.C.
va	12	<i>Viburnum acerifolium</i> NARLE-LEAF VIBURNUM	50cm ht. 3.0 gal. pot.	PLANT AT 2.0m O.C.

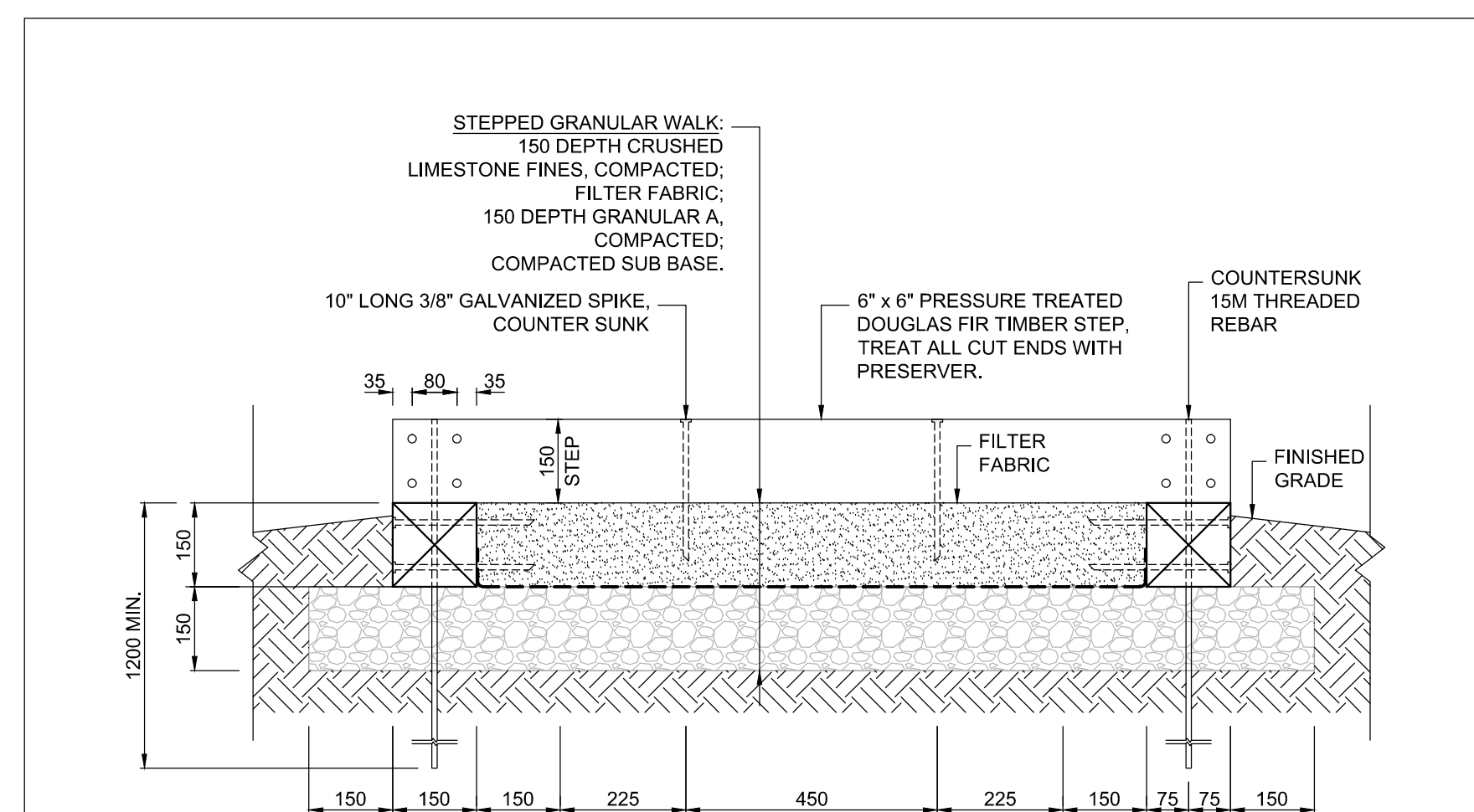
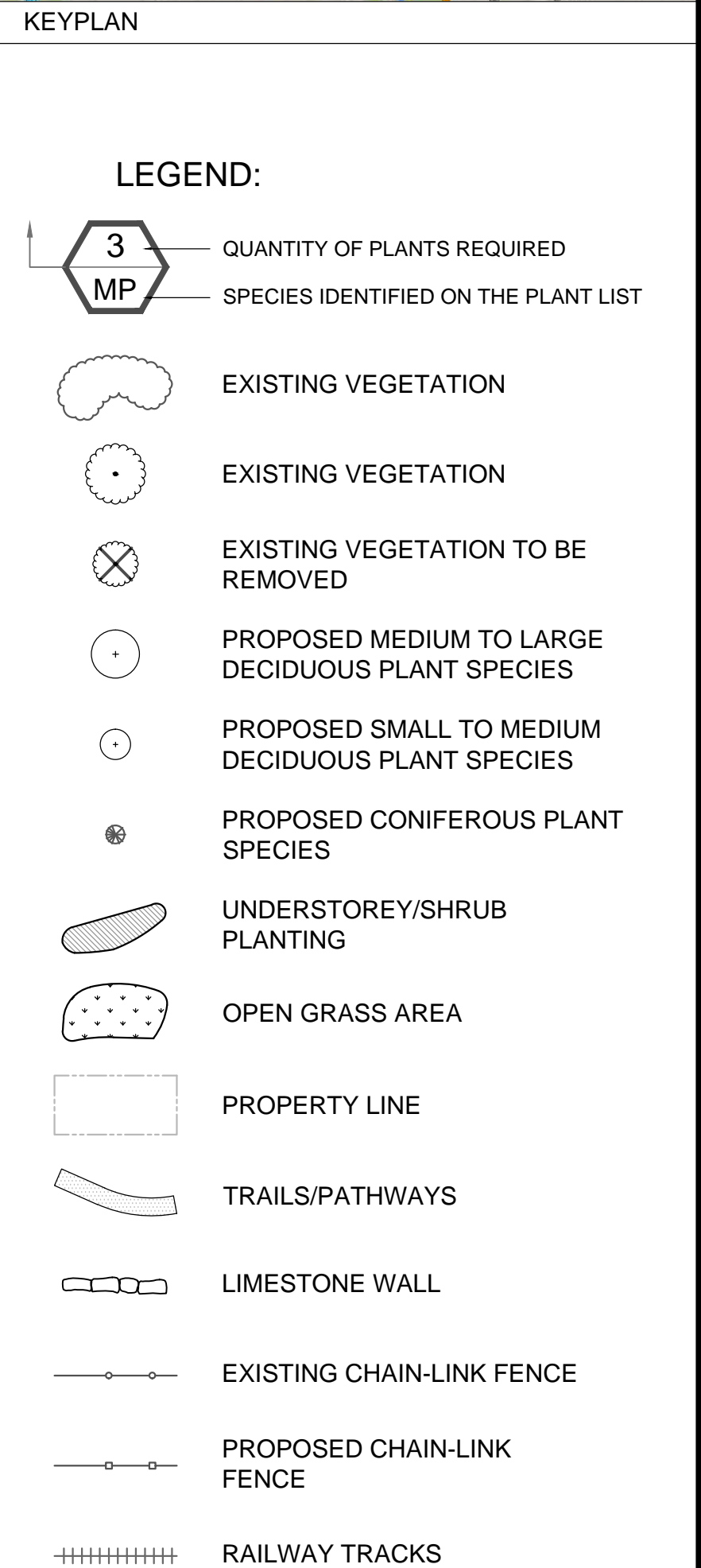

TIMBER STEP SECTION "S2"

NOTE:

1. WRAP FILTER FABRIC UPWARD AT EDGES TO BE FLUSH WITH TOP OF LIMESTONE FINES LAYER
2. ALL MEASUREMENTS ARE MILLIMETERS UNLESS OTHERWISE STATED

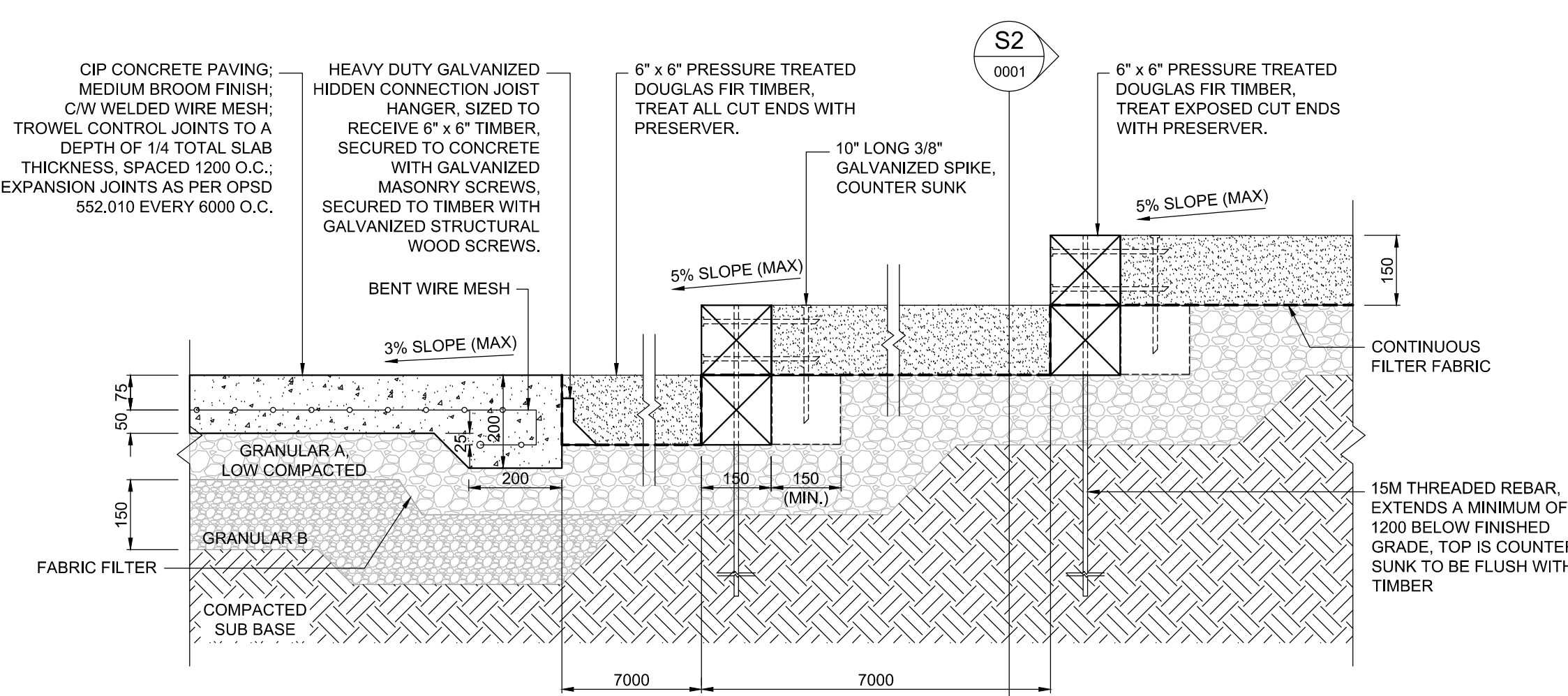

TIMBER STEP AT CONCRETE WALK SECTION "S1"



WIMBER STEP DETAIL

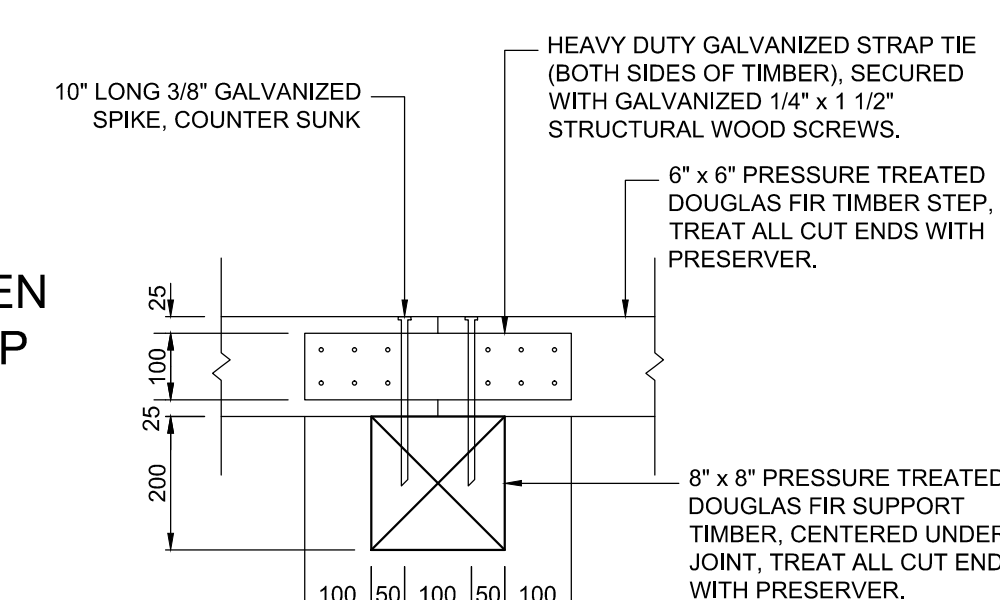

INCOMPLETE DETAIL

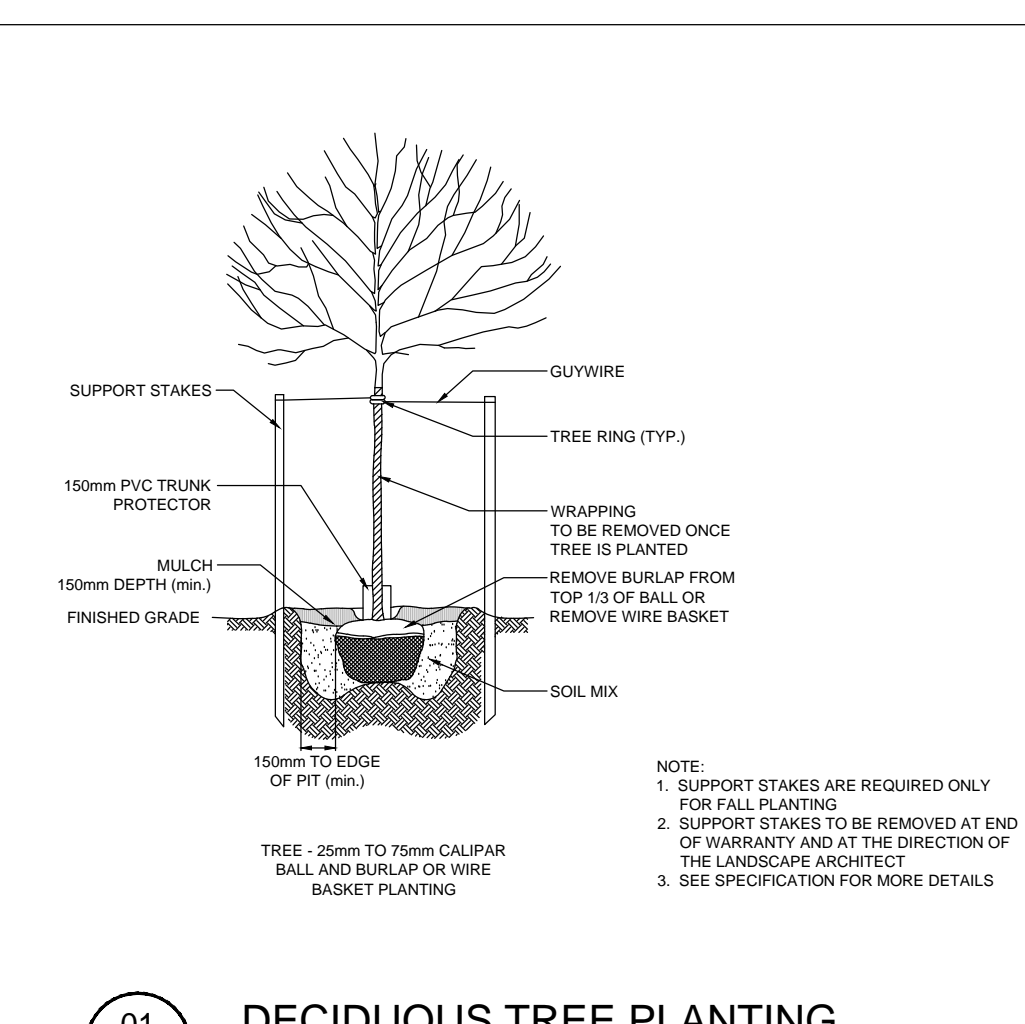

01 DECIDUOUS TREE PLANTING
0001 DETAIL

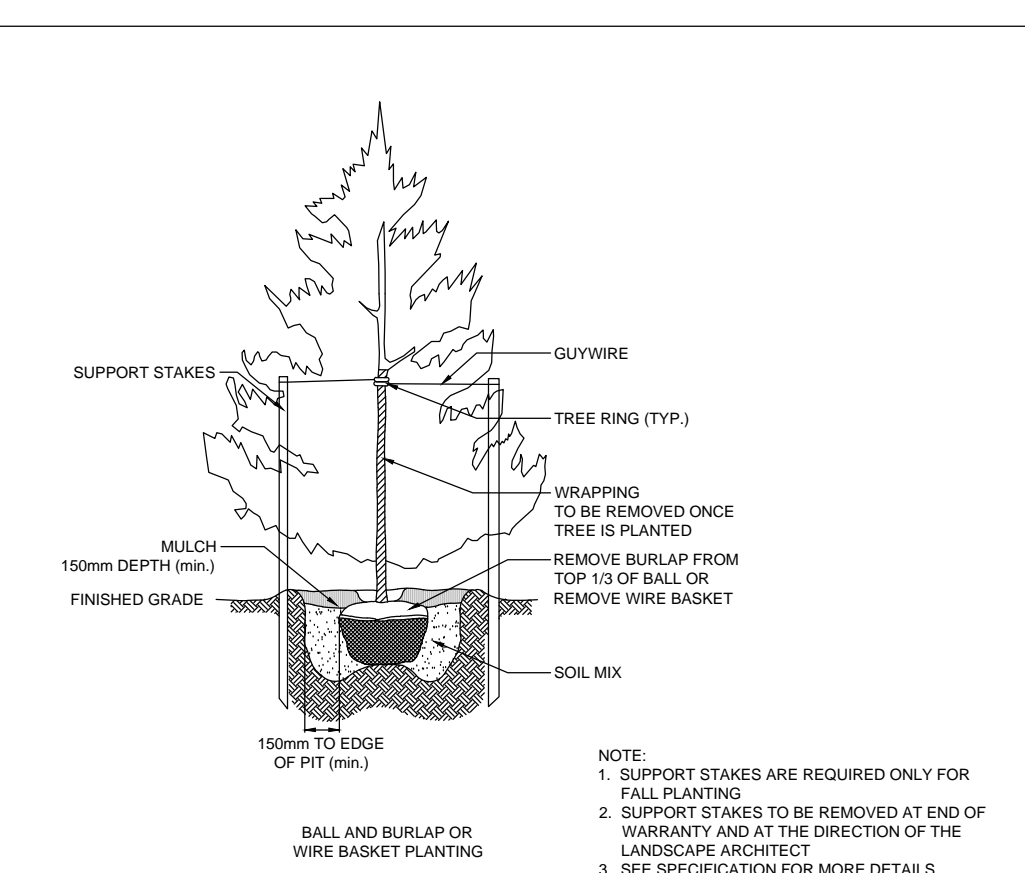

02 CONIFEROUS TREE PLANTING
0001 DETAIL

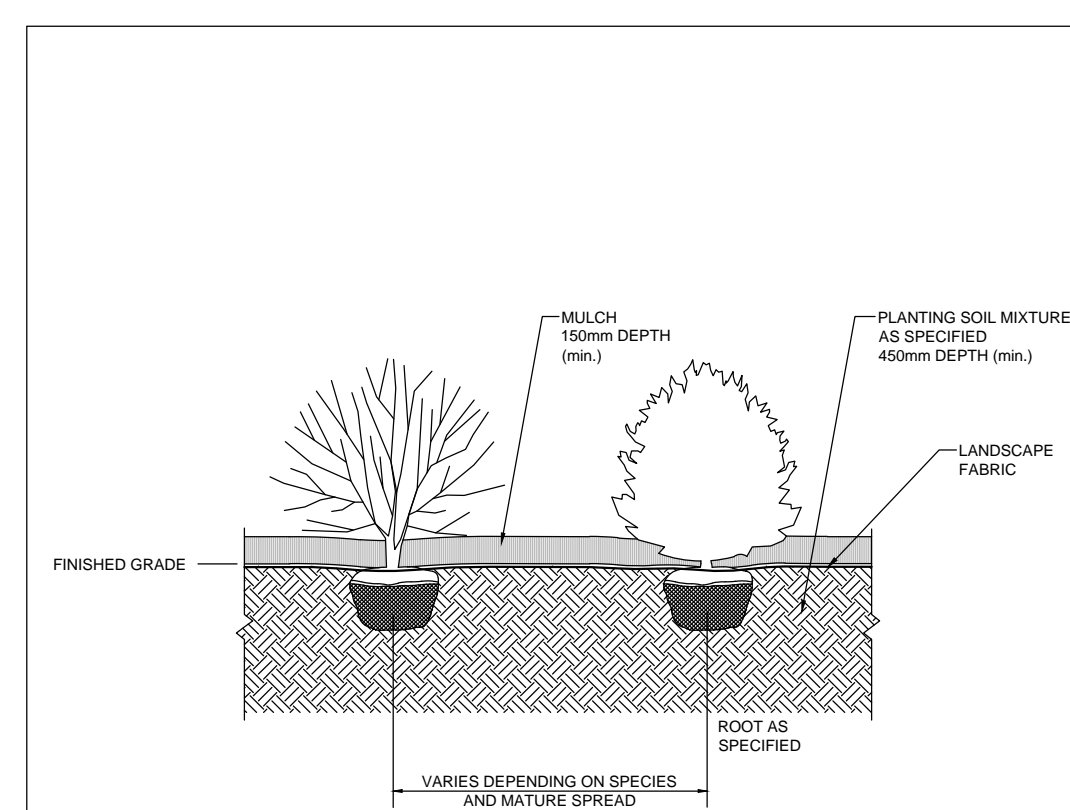

03 SHRUB BED PLANTING
0001 DETAIL

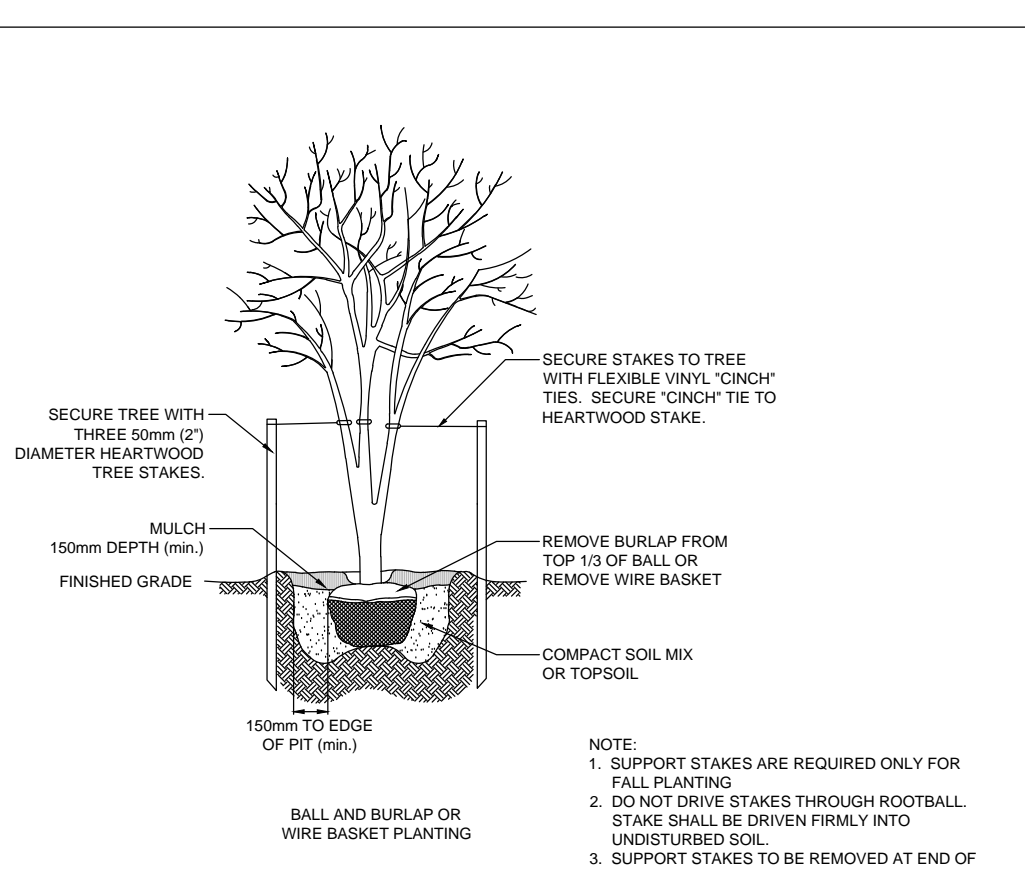

04 MULTISTEM PLANTING
0001 DETAIL

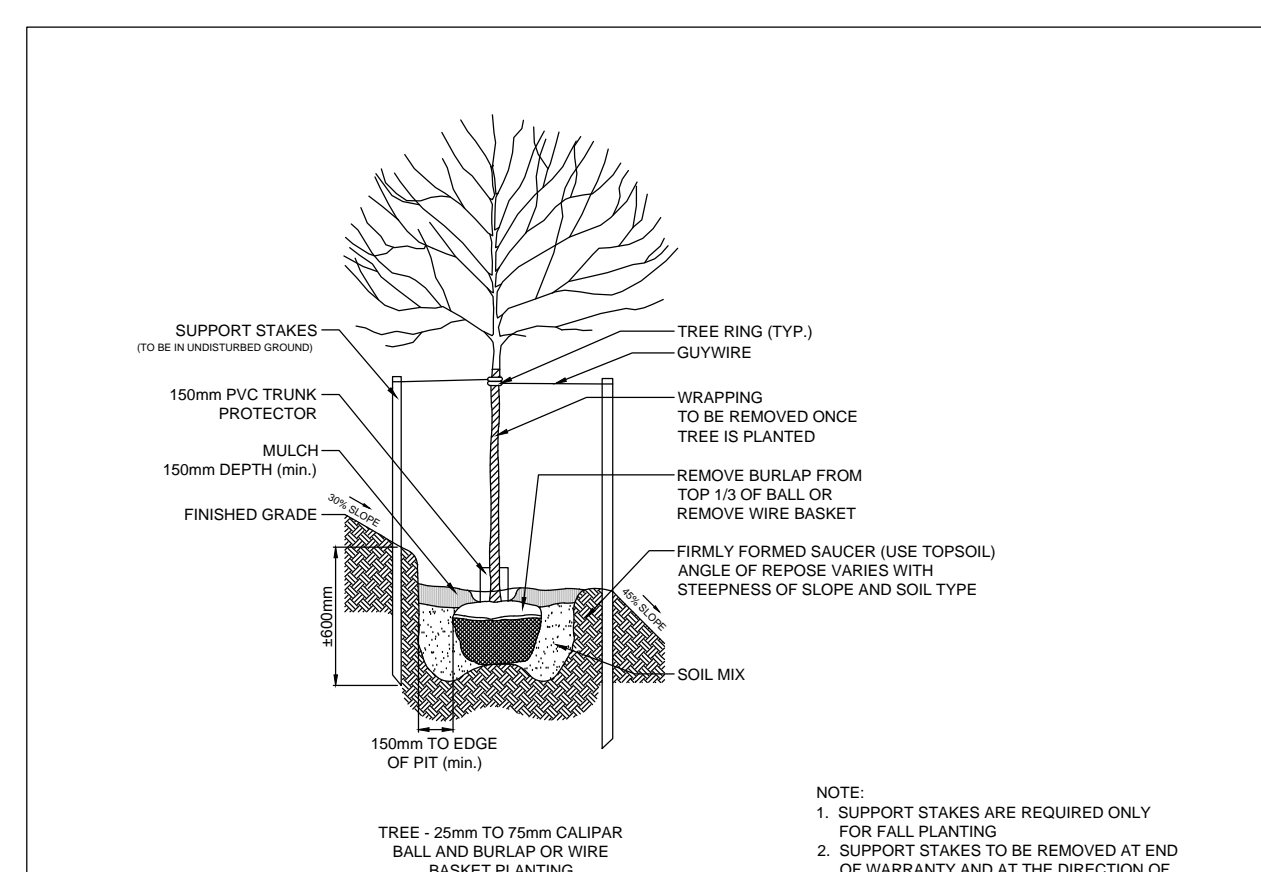

05 DECIDUOUS TREE PLANTING ON SLOPE
0001 DETAIL NT

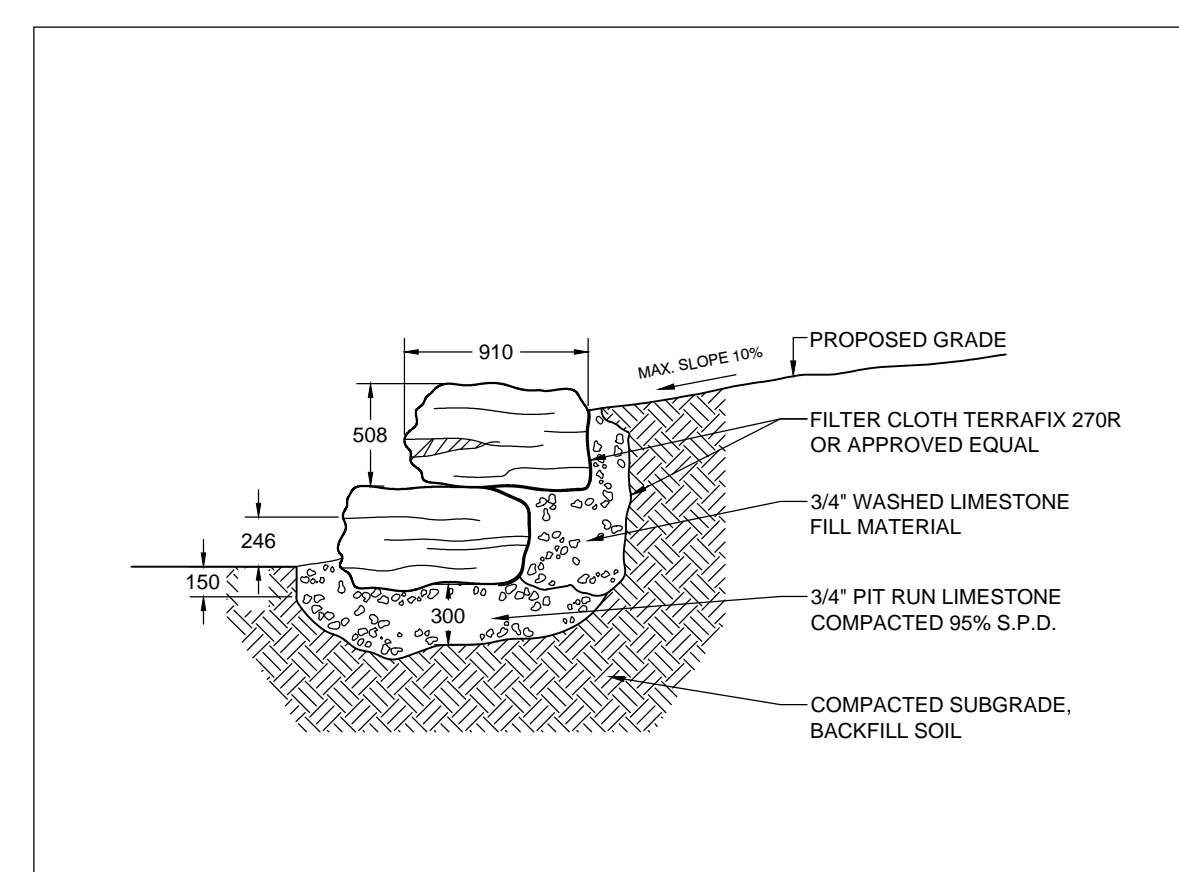

06 LIMESTONE WALL CONSTRUCTION
0001 DETAIL

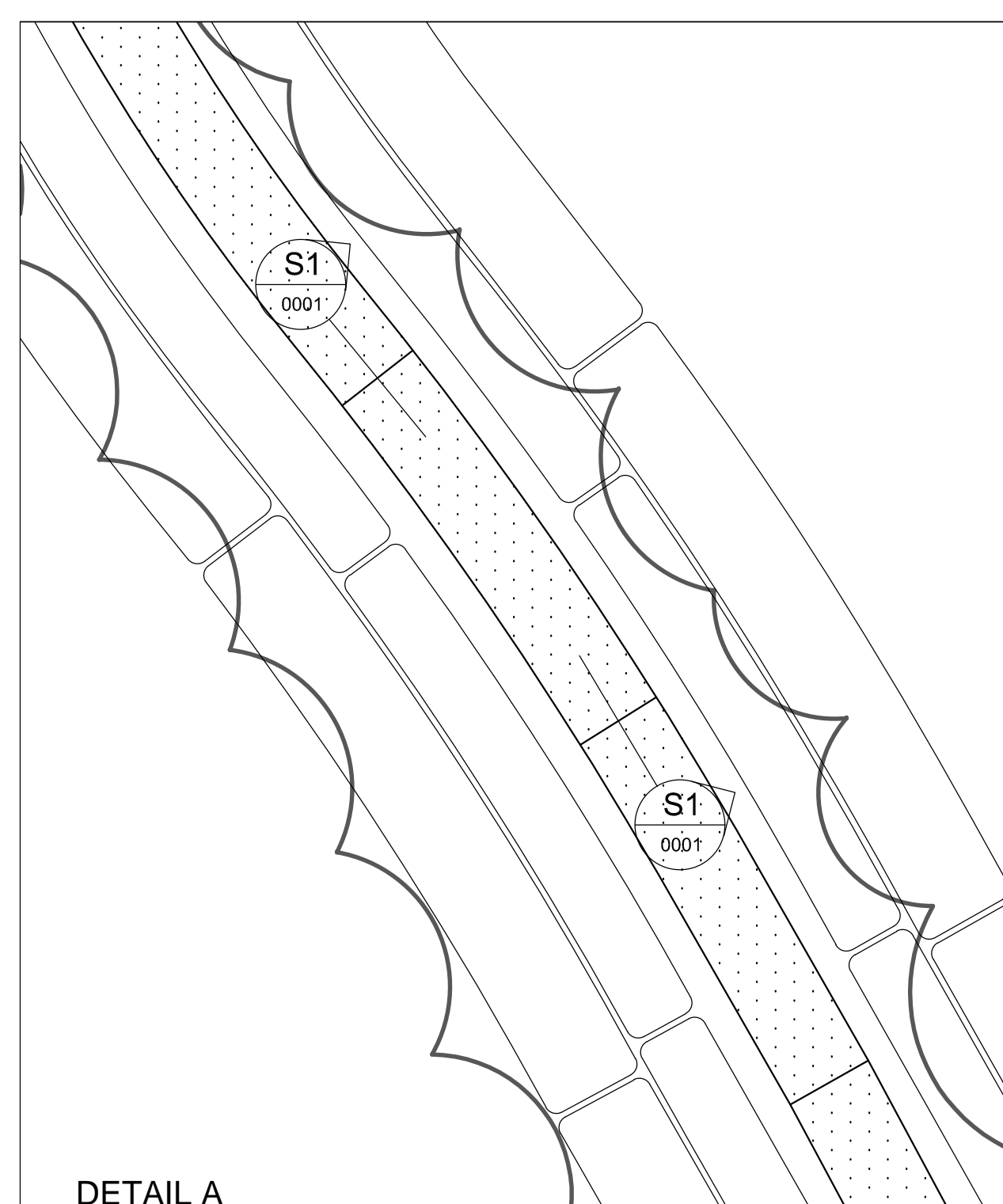

DETAIL A